



ENVIROTEK FORESTRY CONSULTING, LLC TIMBER SALE # 121

David Brouchous Property; Ridgeway; Wisconsin

36 acres; T07N; R04E; Section(s) 27, 34; Ridgeway Twp.; Iowa County; Wisconsin

Harvest Volume Estimates

-Buyers are encouraged to conduct their own inventory-

Board Feet, Scribner Log Rule

Species	5" - 11"			12" - 13" DBH			14" - 15" DBH			16" + DBH			Total Volumes			
	Cords	BDF	Trees	Avg.	BDF	Trees	Avg.	BDF	Trees	Avg.	BDF	Trees	Avg.	Cords	BDF	Trees
Black Oak	20	340	8	43	2,780	42	66	16,220	101	161	20	19,340	151			
White Oak	21	60	2	30	1,300	22	59	4,820	41	118	21	6,180	65			
Bur Oak	38	100	3	33	880	17	52	1,700	19	89	38	2,680	39			
Red Oak	0	0	0	0	80	1	80	840	5	168	0	920	6			
Basswood	9	200	4	50	740	11	67	2,780	16	174	9	3,720	31			
Black Cherry	13	60	2	30	900	15	60	2,820	22	128	13	3,780	39			
Red Maple	12	100	3	33	120	2	60	1,740	15	116	12	1,960	20			
Elm	22	240	8	30	700	12	58	2,520	22	115	22	3,460	42			
Walnut	0	20	1	20	80	1	80	0	0	0	0	100	2			
Misc. H hardwoods	27	60	2	30	420	6	70	2,100	12	175	27	2,580	20			
Aspen	149	0	0	0	0	0	0	0	0	0	149	0	0			
Designated Timber	311	1,180	33	36 BDF	8,000	129	62 BDF	35,540	253	140 BDF	311	44,720	415			

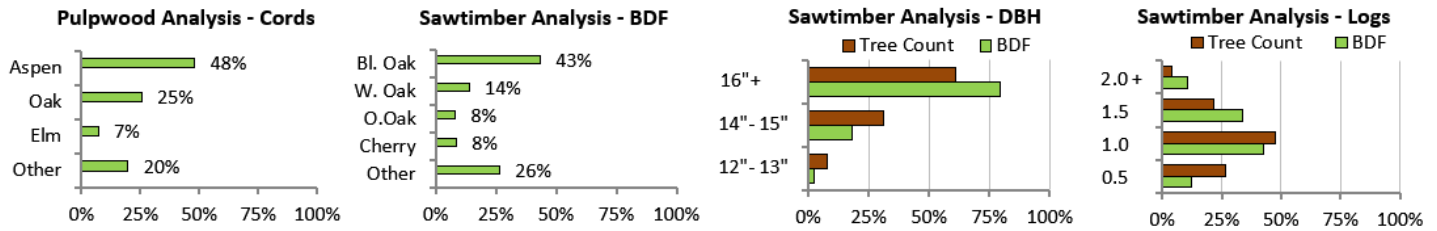

- ➡ Cordwood estimated by cruise - BAF 10 prism. Utilization of topwood would add 45 cords (1 cord/1,000 BDF).
- ➡ Converting 12"-13" sawtimber to bolts would add 2.6 cords while reducing total BDF by 1,180.

Conditions of Sale:

- Contract length is until April 1, 2025.
- A 20% down payment is required with the balance due before logging begins.
- The Seller will guarantee Purchaser use of the Log Truck Route(s) = = = and Log Landing(s) "🌲", as shown on the attached aerial photo, for the sole purpose of harvesting operations authorized by this Contract.
- No cutting or skidding will be allowed during the time period of April 1st – October 16th as a precaution against Oak Wilt disease, and to protect possible endangered/threatened species and/or habitat. No logging operations will be allowed during the gun deer hunting season.
- Existing and constructed trails used by the Purchaser must be graded and cleared of logging slash upon completion of logging operations authorized by this Contract.

Cutting Specifications: Utilization of Designated Timber is optional. All Designated Timber must be felled or girdled.

Management Prescriptions: Patch Selection (blue areas) and Coppice (red areas)

- ➡ **Within the timber sale boundary, designated on the ground with blue flagging, and on the associated map, Blue lines:**
 - Harvest all merchantable aspen, elm, locust, boxelder, birch, ash. Purchaser is not excluded from utilizing less than 5 inch DIB.
 - Harvest all trees marked on the bole and stump in BLUE paint.
- ➡ **Within the Red paint lines designated on the ground, and on the associated map with a red line and labeled "CC": Coppice**
 - Harvest all tree species 2 inches DIB and greater. Purchaser is not excluded from utilizing less than 2 inch DIB.

Merchantable volume defined as Designated Timber containing at least (1) 100 inch stick with a minimum top diameter of 5 inches DIB and greater.

General Information:

- ✓ All Designated Timber is FSC 100% (MFL# 25-033-2013). Certification chain of custody ends at stump, landing, or roadside.
- ✓ **No Crop Restriction**
- ✓ Landowner owns Log Truck Route and associated woods roads.
- ✓ Gate at Korback is Road is closed but not locked. Please close after visit.
- ✓ Marks are fading. If purchaser requests, Envirotek will freshen marks.

FOR LOCATION AND AERIAL PHOTO OF TIMBER SALE # 121 TURN THIS PAGE OVER

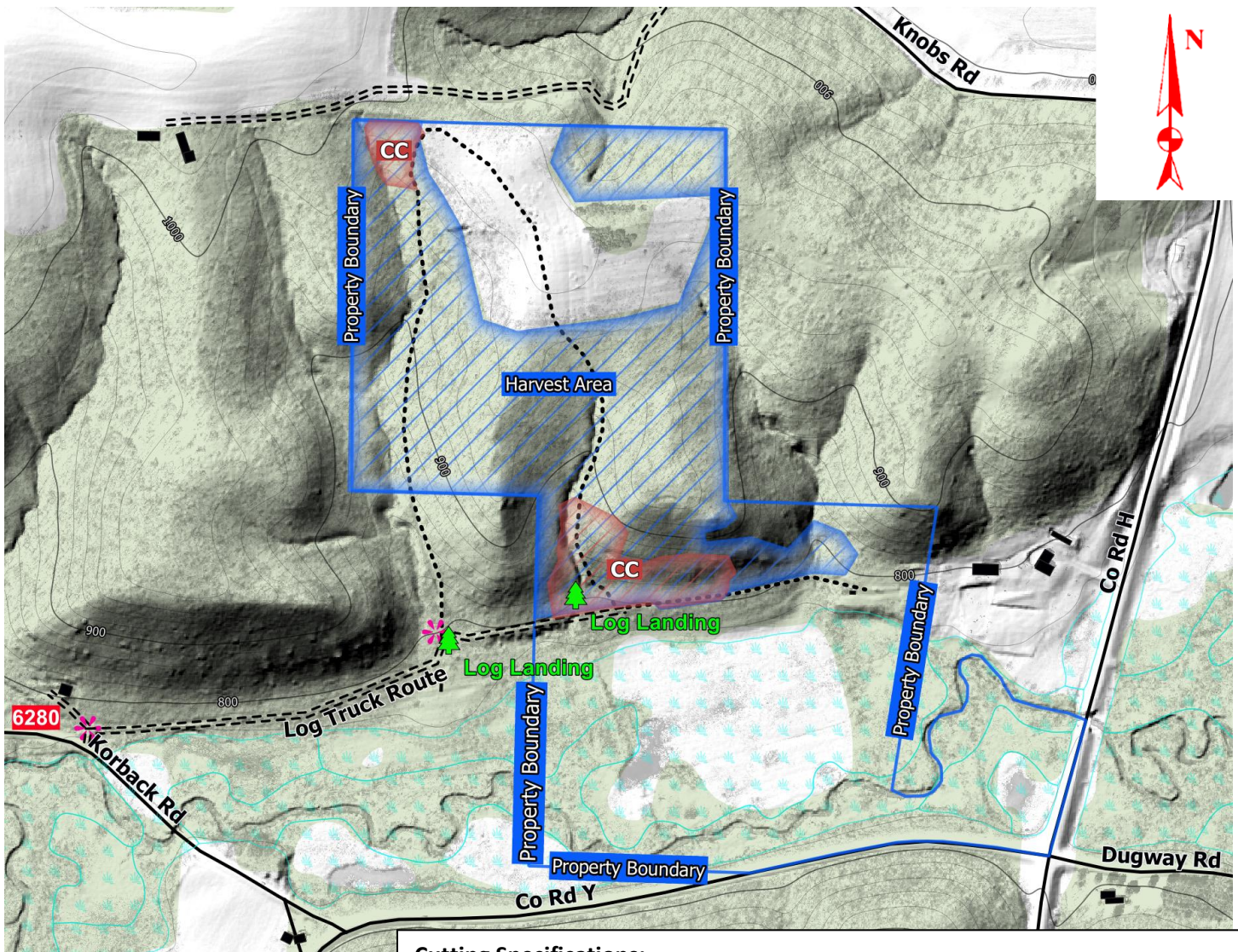

Cutting Specifications:

- **Within the timber sale boundary, designated on the ground with blue flagging, and on the associated map, Blue lines:**
 1. Harvest all merchantable aspen, elm, locust, boxelder, birch, ash. Purchaser is not excluded from utilizing less than 5 inch DIB.
 2. Harvest all trees marked on the bole and stump in BLUE paint.
- **Within the Red paint lines designated on the ground, and on the associated map with a red line and labeled "CC":**
 1. Harvest all tree species 2 inches DIB and greater. Purchaser is not excluded from utilizing less than 2 inch DIB.

