



ENVIROTEK FORESTRY CONSULTING, LLC TIMBER SALE # 119

Kyle Blasch et al Property; Hollandale; Wisconsin

32 acres; T04N; R04E; Section 11; Waldwick Twp.; Iowa County; Wisconsin

Harvest Volume Estimates

-Buyers are encouraged to conduct their own inventory-

Board Feet, Scribner Log Rule

Species	5" - 11"				12" - 13" DBH			14" - 15" DBH			16" + DBH			Total Volumes		
	Cords	BDF	Trees	Avg.	BDF	Trees	Avg.	BDF	Trees	Avg.	BDF	Trees	Avg.	Cords	BDF	Trees
Walnut	9	380	13	29	1,060	19	56	7,040	51	138	9	8,480	83	9	8,480	83
Basswood	35	600	16	38	4,780	74	65	8,960	60	149	35	14,340	150	35	14,340	150
Elm	23	220	8	28	720	13	55	740	8	93	23	1,680	29	23	1,680	29
Black Oak	1	20	1	20	0	0	0	440	3	147	1	460	4	1	460	4
White Oak	1	0	0	0	0	0	0	300	3	100	1	300	3	1	300	3
Bur Oak	1	0	0	0	80	2	40	140	2	70	1	220	4	1	220	4
Misc. Hardwoods	9	0	0	0	0	0	0	0	0	0	9	0	0	9	0	0
Aspen	16	0	0	0	0	0	0	0	0	0	16	0	0	16	0	0
Designated Timber	95	1,220	38	<i>32 BDF</i>	6,640	108	<i>61 BDF</i>	17,620	127	<i>139 BDF</i>	95	25,480	273	95	25,480	273

Pulpwood Analysis - Cords

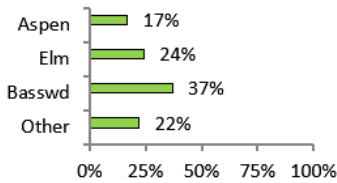

Sawtimber Analysis - BDF

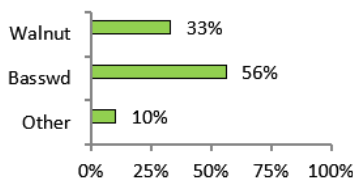

Sawtimber Analysis - DBH

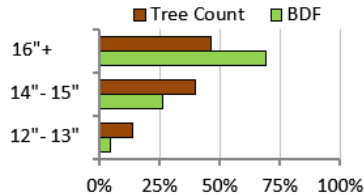

Sawtimber Analysis - Logs

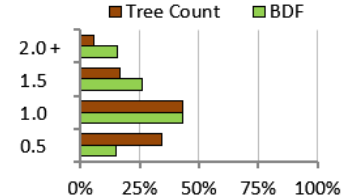

- ➡ Cordwood estimated by cruise - BAF 10 prism. Utilization of topwood would add 25 cords (1 cord/1,000 BDF).
- ➡ Converting 12"-13" sawtimber to bolts would add 2 cords while reducing total BDF by 1,220 ft.

Conditions of Sale:

- Contract length is until April 1, 2025.
- A 15% down payment is required with the balance due before logging begins.
- The Seller will guarantee Purchaser use of the Log Landing(s) as shown on the attached aerial photo, for the sole purpose of harvesting operations authorized by this Contract.
- No logging operations will be allowed during the gun deer hunting season.
- No felling, bucking or skidding shall be allowed in the "creek", as shown on the attached aerial photo.
- Existing and constructed trails used by the Purchaser must be graded and cleared of logging slash upon completion of logging operations authorized by this Contract.
- Harvest trees are marked with BLUE paint.

Cutting Specifications: Utilization of Designated Timber is optional. All Designated Timber must be felled or girdled.

Silvicultural Prescription: Group Selection

- ➡ **Within the timber sale boundary, designated on the ground with blue flagging, and on the associated map, a blue line:**
 - Harvest all merchantable aspen, elm, boxelder, birch, ash. Purchaser is not excluded from utilizing less than 5 inch dib.
 - Harvest all trees marked on the bole and stump in BLUE paint.

Merchantable volume defined as Designated Timber containing at least (1) 100 inch stick with a minimum top diameter of 5 inches dib and greater.

General Information:

- ✓ All Designated Timber is FSC 100% (MFL # 25-026-2014). Certification chain of custody ends at stump, landing, or roadside.
- ✓ No Oak Wilt restriction.
- ✓ No crop off restriction.
- ✓ This sale is easily logged mechanically. Fairly level terrain with 2 roadside log landings.

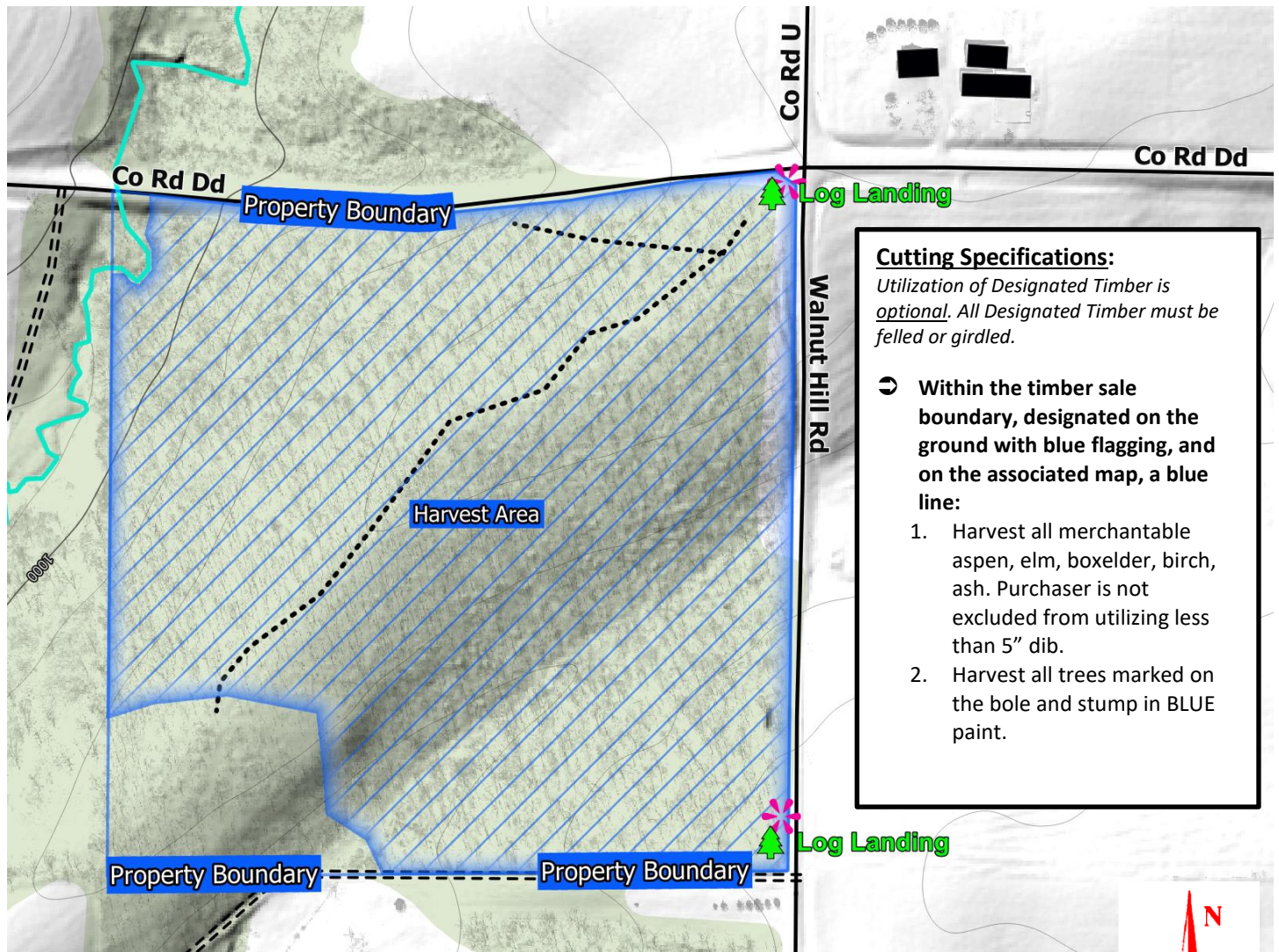

Cutting Specifications:
Utilization of Designated Timber is optional. All Designated Timber must be felled or girdled.

➤ **Within the timber sale boundary, designated on the ground with blue flagging, and on the associated map, a blue line:**

1. Harvest all merchantable aspen, elm, boxelder, birch, ash. Purchaser is not excluded from utilizing less than 5" dib.
2. Harvest all trees marked on the bole and stump in BLUE paint.

